

Frame Fit Specifications

X0™ • X9™ • X7™ • X5™

The benefits SRAM 2X10 and 3X10 delivers—a full range of usable gears, less weight, easier and smoother shifting in all terrains—are becoming understood by riders of all levels, not just cross country pros. To fully appreciate how SRAM 2X10 and 3X10 can help you make the most of your ride, we wanted to provide a comprehensive frame fit resource with the specifications you need to deliver the benefits of a 2X10 or 3X10 drivetrain to your customers.



Table of Contents

FRONT DERAILLEURS	3
X0 • X9 • X7 • X5 FRONT DERAILLEURS - LOW & HIGH CLAMP MOUNT	4
X0 • X9 • X7 • X5 FRONT DERAILLEURS - LOW & HIGH CLAMP MOUNT	6
X0 • X9 • X7 FRONT DERAILLEURS - HIGH DIRECT MOUNT	7
X0 • X9 • X7 FRONT DERAILLEURS - LOW DIRECT MOUNT	9
REAR DERAILLEURS	12
X0 • X9 • X7 • X5 REAR DERAILLEURS	13
CRANKSETS	14
X0 CRANKSETS [2X10]	15
X0 CRANKSETS [3X10]	16
X9 CRANKSETS [2X10]	17
X9 CRANKSETS [3X10]	18
X7 CRANKSETS [2X10]	19
X7 CRANKSETS [3X10]	20
X5 CRANKSETS [2X10]	21
X5 CRANKSETS [3X10]	22
BOTTOM BRACKETS	23
PRESSFIT™ 30 BB	24
PRESSFIT™ GXP BB	25

Front Derailleurs

X0 · X9 · X7 · X5 Front Derailleurs - Low & High Clamp Mount

		CLAMP POSITION ¹				TIRE & CHAINSTAY CLEARANCE - SWING ARM FULLY COMPRESSED			
		Chain Ring Combination	A	B	C	D	E	F	G ² at $\alpha = 66^\circ$ at $\alpha = 69^\circ$
2x10	Low Clamp	39/26	56 mm	76 mm	-	101 mm	48 mm [X0, X9] 46 mm [X7]	31 mm	13 mm 17 mm
		42/28	62 mm	82 mm		107 mm			19 mm 23 mm
	High Clamp	39/26	117 mm	136 mm	85 mm	-	36 mm	33 mm	23 mm 27 mm
		42/28	123 mm	142 mm	91 mm				29 mm 33 mm
3x10	Low Clamp	44/33/22	65 mm	85 mm	-	110 mm	48 mm [X0, X9] 46 mm [X7]	31 mm	17 mm 22 mm
	High Clamp	44/33/22	129 mm [X0, X9, X7] 132 mm [X5]	148 mm	98 mm	-	36 mm	31 mm	24 mm 29 mm

¹Leave adequate clearance between bottle cage mounts and front derailleur clamp.

²Be sure to consider the full travel range for suspension frames.

X0 · X9 · X7 · X5 Front Derailleurs - Low & High Clamp Mount

ALL LOW CLAMP

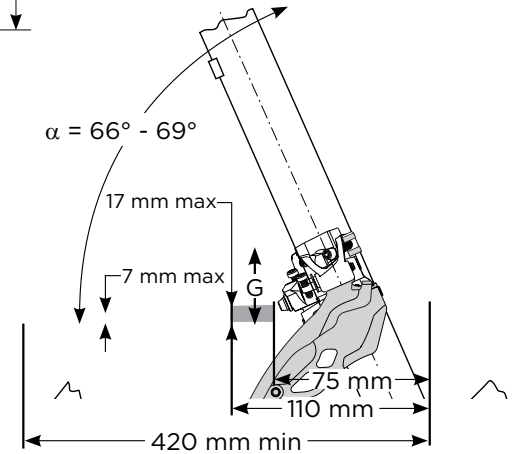
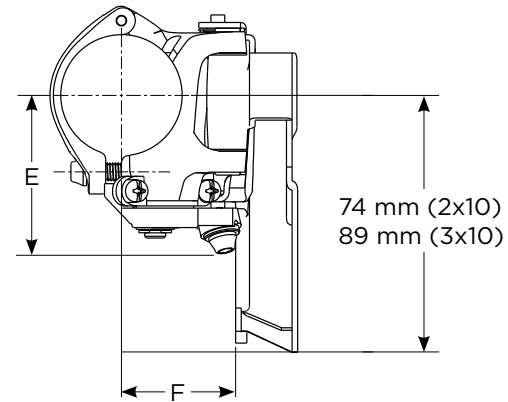
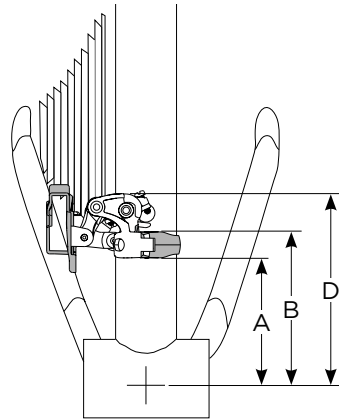
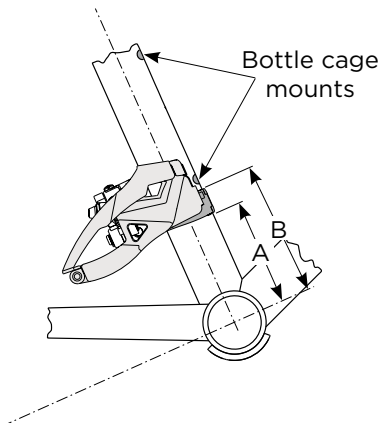

ALL HIGH CLAMP

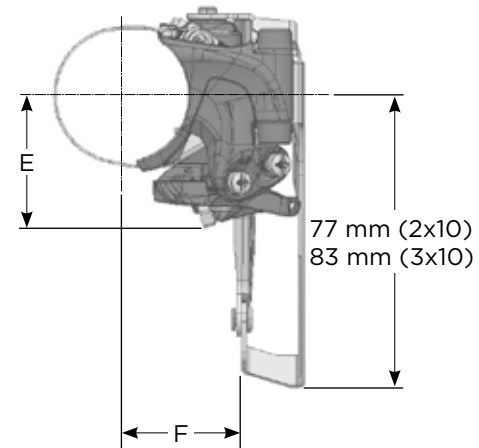
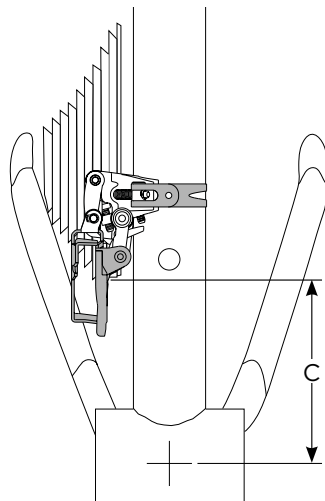
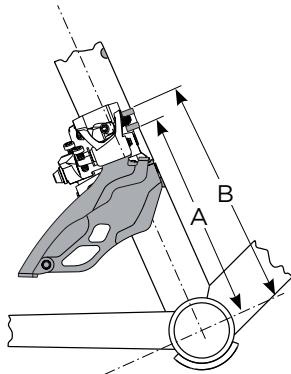

X0 · X9 · X7 · X5 Front Derailleurs - Low & High Clamp Mount

		FRONT DERAILLEUR FRAME COMPATIBILITY AND CAPACITY INFORMATION						
		Clamp Diameter	Rear Capacity	Index	Cable Routing	Chain Stay Angle α	Chain Line	Material
2x10	Low Clamp	31.8 mm [with adapter] 34.9 mm 38.2 mm [X-0]	10 speed	Yes	Top Pull or Bottom Pull	66° - 69°	49.5 mm	Body - Die Cast Aluminum Cage - Steel Clamp - Aluminum Link - Forged/Cast Aluminum
	High Clamp	31.8 mm 34.9 mm 38.2 mm [X-0, X-9]						Body - Die Cast Aluminum Cage - Steel Clamp - Stainless Steel Link - Forged/Cast Aluminum
3x10	Low Clamp	31.8 mm [with adapter] 34.9 mm 38.2 mm [X-0]	10 speed	Yes	Top Pull or Bottom Pull	66° - 69°	51 mm	Body - Die Cast Aluminum Cage - Steel Clamp - Aluminum Link - Forged/Cast Aluminum
	High Clamp	31.8 mm 34.9 mm 38.2 mm [X-0, X-9]						Body - Die Cast Aluminum Cage - Steel Clamp - Stainless Steel Link - Forged/Cast Aluminum

X0 · X9 · X7 Front Derailleurs - High Direct Mount

PLATE BODY POSITION					TIRE & CHAINSTAY CLEARANCE - SWING ARM FULLY EXTENDED			
	Chain Ring Combination	A	B	C	D ¹		E	F
					at $\alpha = 66^\circ$	at $\alpha = 69^\circ$		
2x10	39/26	165.5 mm ± 1.0 mm	26 mm	85 mm	23 mm	27 mm	34 mm	33 mm
	42/28	171.5 mm ± 1.0 mm		91 mm	29 mm	33 mm		
3x10	44/33/22	178.5 mm ± 1.0 mm	26 mm	98 mm	24 mm	29 mm	34 mm	31 mm

¹Be sure to consider the full travel range for suspension frames.

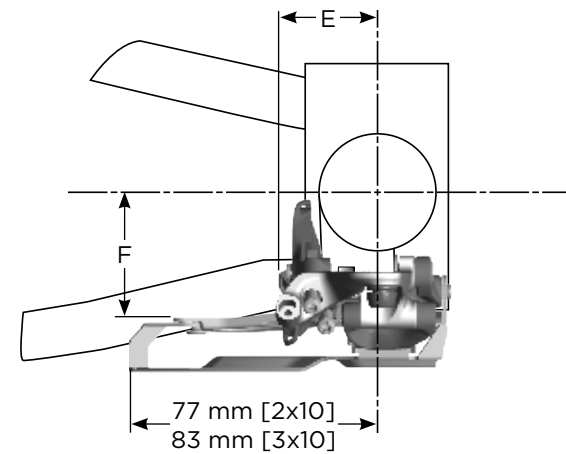
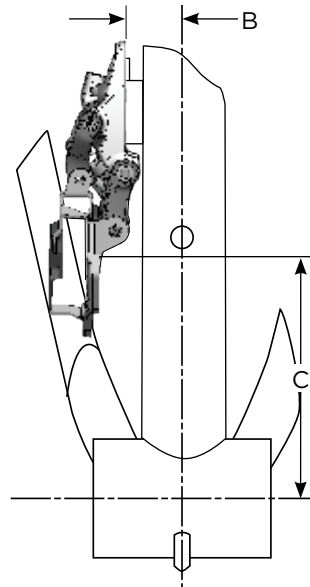
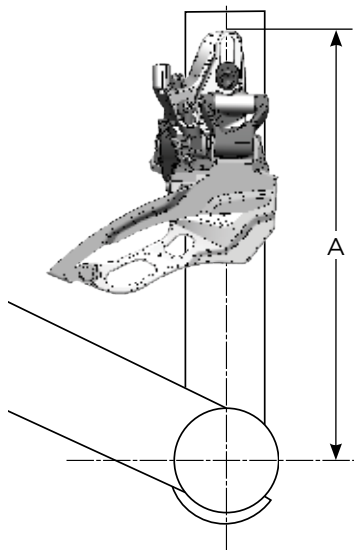
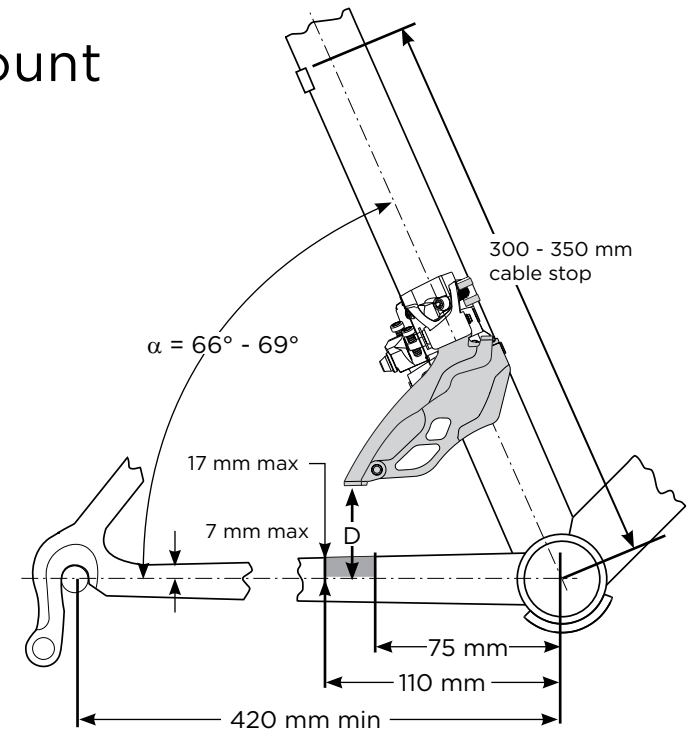

X0 · X9 · X7 Front Derailleurs - High Direct Mount

FRONT DERAILLEUR FRAME COMPATIBILITY AND CAPACITY INFORMATION						
	Rear Capacity	Index	Cable Routing	Chain Stay Angle α	Chain Line	Material
ALL HIGH DIRECT MOUNT	10 speed	Yes	Top Pull or Bottom Pull	66° - 69°	49.5 mm [2x10] 51 mm [3x10]	Body - Die Cast Aluminum Cage - Steel Link - Forged/Cast Aluminum

ALL HIGH DIRECT MOUNT FRAME BUILD REQUIREMENTS (All dimensions in millimeters unless otherwise indicated - not to scale)

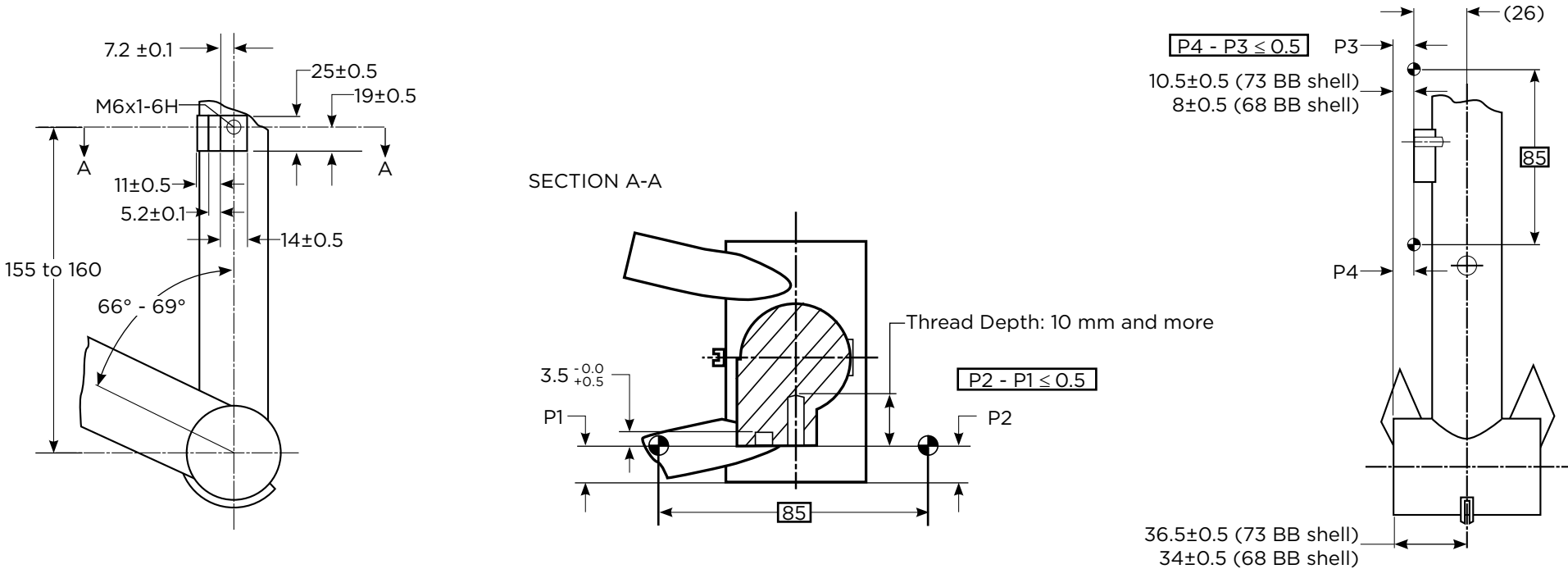

X0 · X9 · X7 Front Derailleurs - Low Direct Mount

MOUNTING HOLE POSITION - SWING ARM FULLY EXTENDED								FRONT DERAILLEUR CLEARANCE - SWING ARM FULLY COMPRESSED		
LOW DIRECT MOUNT	θ	A	B	C	D (BB shell width)		E	F	G	d_{max}
					68 mm	73 mm				
					14.8 mm ± 0.15 mm	17.3 mm ± 0.15 mm	-	65 mm	48 mm	38.2 mm
	S1	$45.5^\circ \pm 1^\circ$	48.9 mm ± 0.15 mm	42.7 mm ± 0.1 mm	63 mm ± 0.2 mm	7 mm ± 0.15 mm	9.5 mm ± 0.15 mm	5 mm ± 0.1 mm		
	S3	66° or 69° ($\theta = \alpha$)	54 mm ± 0.15 mm	22.1 mm ± 0.05 mm	5 mm ± 0.05 mm	7 mm ± 0.15 mm	9.5 mm ± 0.15 mm	5 mm ± 0.1 mm		

LOW DIRECT MOUNT TYPE : S1

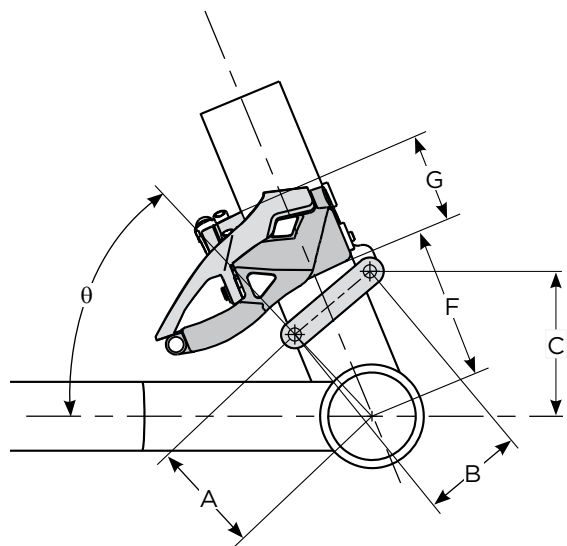

DIRECT MOUNT TYPE : S3

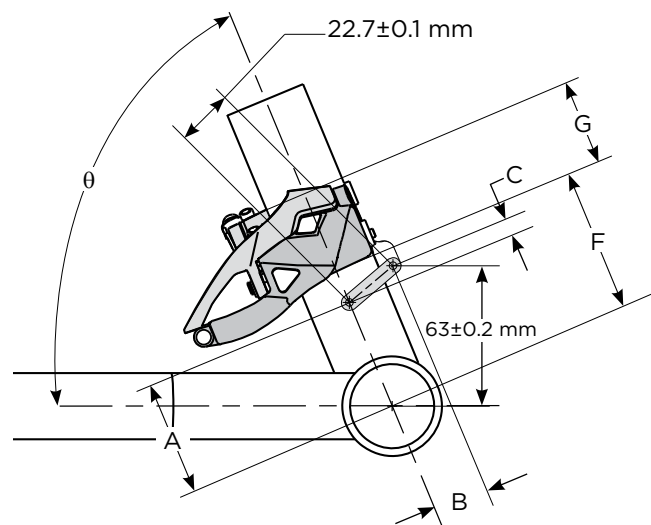

X0 · X9 · X7 Front Derailleurs - Low Direct Mount

ALL LOW DIRECT MOUNT	FRONT DERAILLEUR CABLE ROUTING - BOTTOM PULL (SWING ARM FULLY EXTENDED)						THREAD DIMENSION	TIRE CLEARANCE		
	H	I	K Chainring Size			δ	ε	L	M	N
			39T	42T	45T					
	13 mm	34 mm	94 mm	100 mm	108 mm	10.5° max	10.5° max	M5.0x0.8-6H	42 mm	29 mm

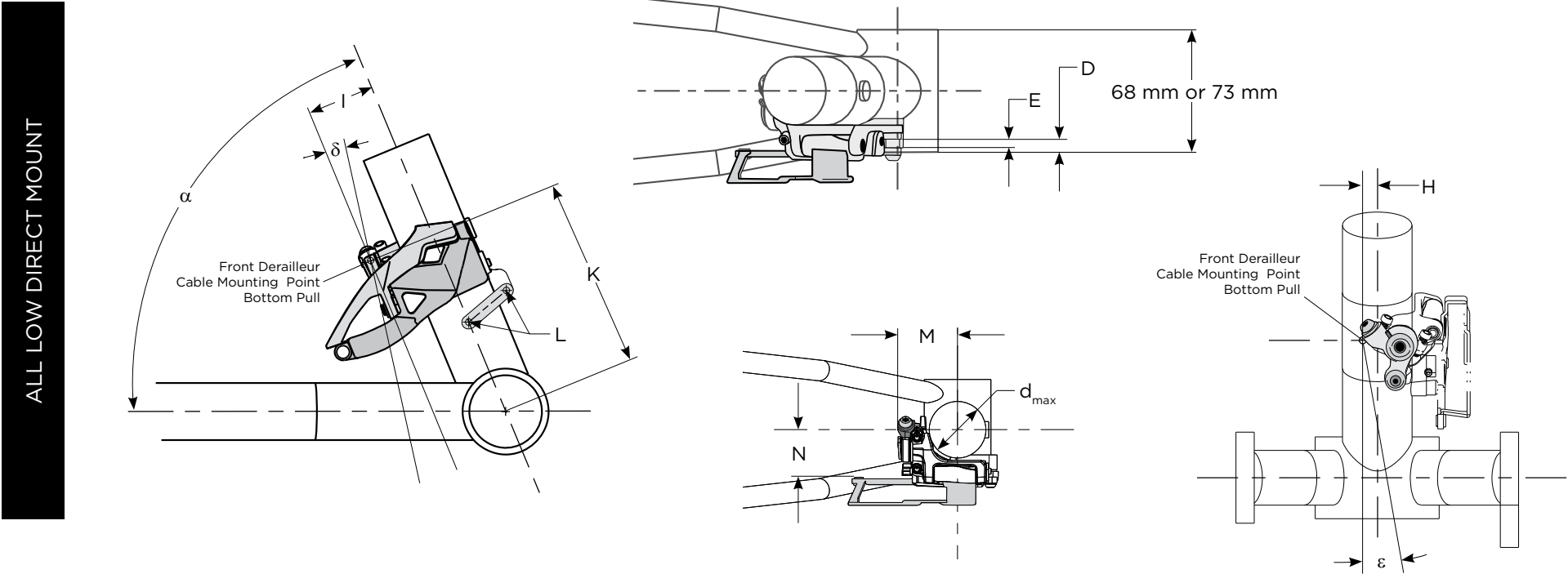

X0 · X9 · X7 Front Derailleurs - Low Direct Mount

	FRONT DERAILLEUR FRAME COMPATIBILITY AND CAPACITY INFORMATION					
	Rear Capacity	Index	Cable Routing	Chain Stay Angle α	Chain Line	Material
ALL LOW DIRECT MOUNT	10 speed	Yes	Top Pull or Bottom Pull	66° - 69°	49.5 mm (Double)	Body - Die Cast Aluminum Cage - Steel
					51 mm (Triple)	

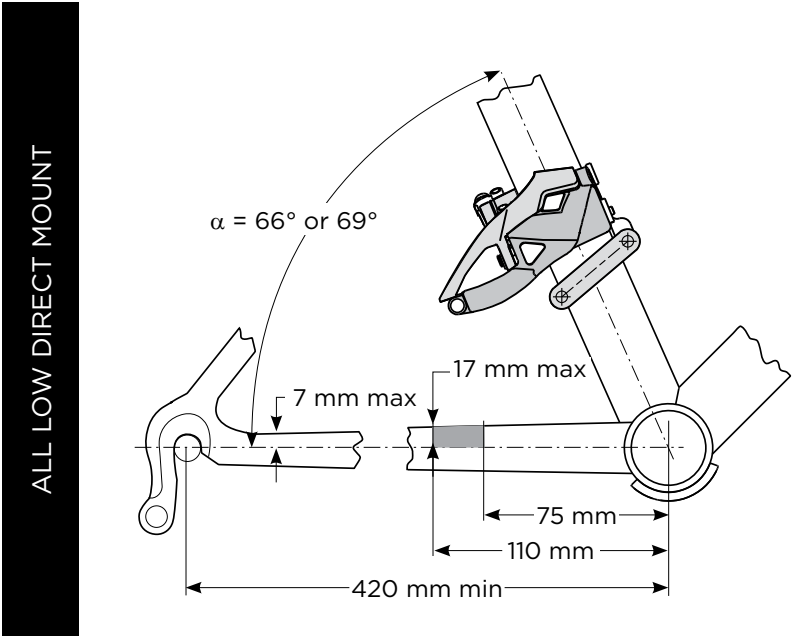

Rear Derailleurs

X0 · X9 · X7 · X5 Rear Derailleurs

1:1 ACTUATION RATIO	REAR DERAILLEUR HANGER SPECIFICATIONS					
	L	X	A	R1	R2	T
	28 mm	8-10 mm	25°-30°	8.5 mm (max)	11.5-13.5 mm	7-8 mm
	30 mm	7.5-10 mm				

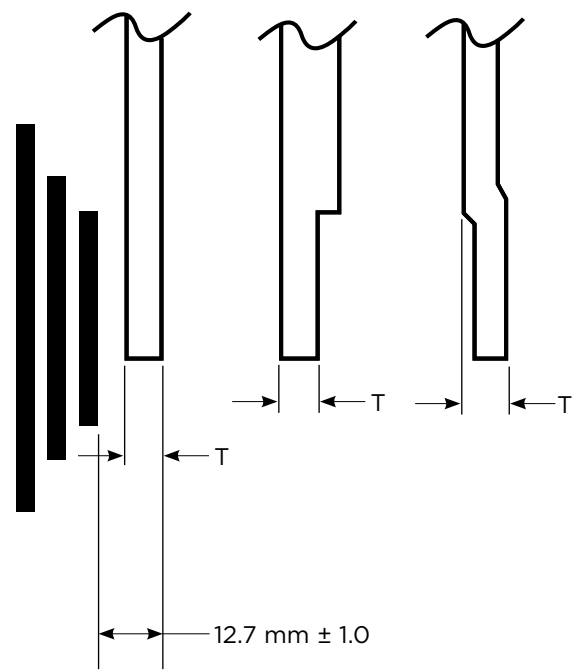
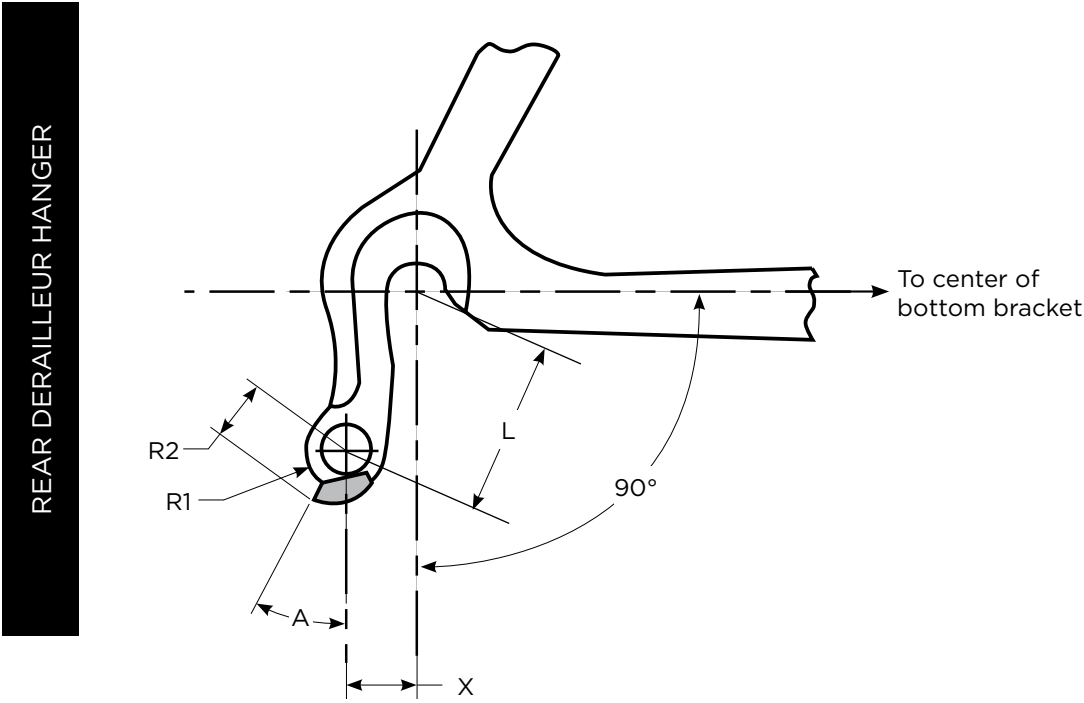

Cranksets

X0 Cranksets [2x10]

CRANKSET FRAME CLEARANCE INFORMATION												
Chain Ring Combination	L1	L2	L3	L4	L5	W1	W2	W3	W4	W5 (min)	W5 (min)	
38/24	24.5 mm	50.7 mm	79.1 mm	82.5 mm (rockguard)	190 mm (172.5 mm and 175 mm crank arm lengths)	41 mm	42 mm	57 mm	55.8 mm (rockguard)	70.5 mm	70.9 mm	
39/26	31 mm	55 mm	81 mm	-		43.5 mm	44.5 mm	52.5 mm	-			
42/28		60 mm	87 mm									
Q-factor										Q167.5	Q167.9	
Bottom Bracket Type(s)										GXP : BB30 : PressFit™ 30 PressFit™ GXP MTB		

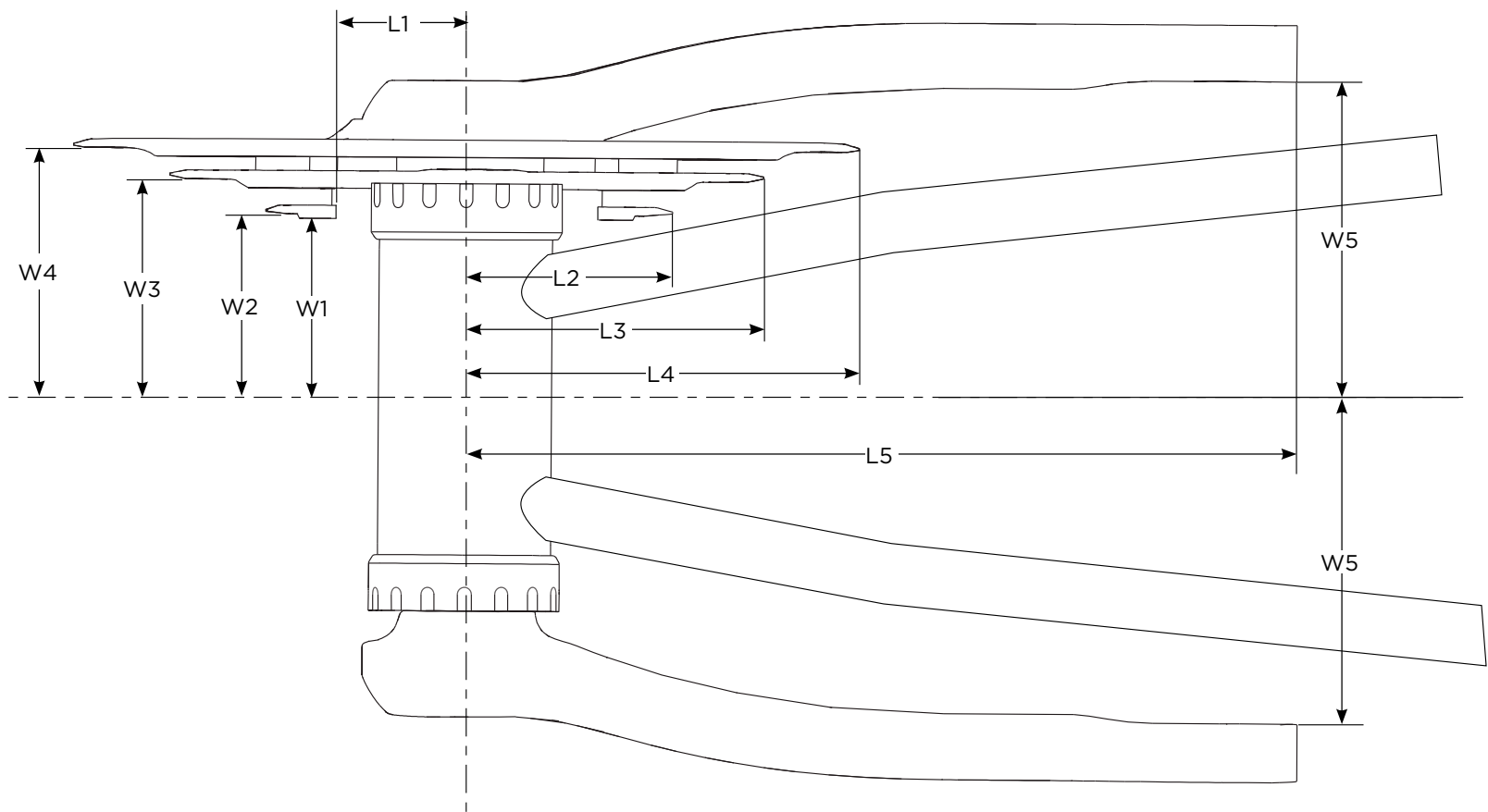

X0 Cranksets [3x10]

CRANKSET [3x10]	CRANKSET FRAME CLEARANCE INFORMATION											
	Chain Ring Combination	L1	L2	L3	L4	L5	W1	W2	W3	W4	W5 (min)	W5 (min)
	44/33/22	25 mm	47 mm	69 mm	91 mm	190 mm (172.5 mm and 175 mm crank arm lengths)	41 mm	42 mm	50 mm	57 mm	70.5 mm	70.9 mm
	Q-factor										Q167.5	Q167.9
	Bottom Bracket Type(s)										GXP : BB30 : PressFit™ 30 PressFit™ GXP MTB	

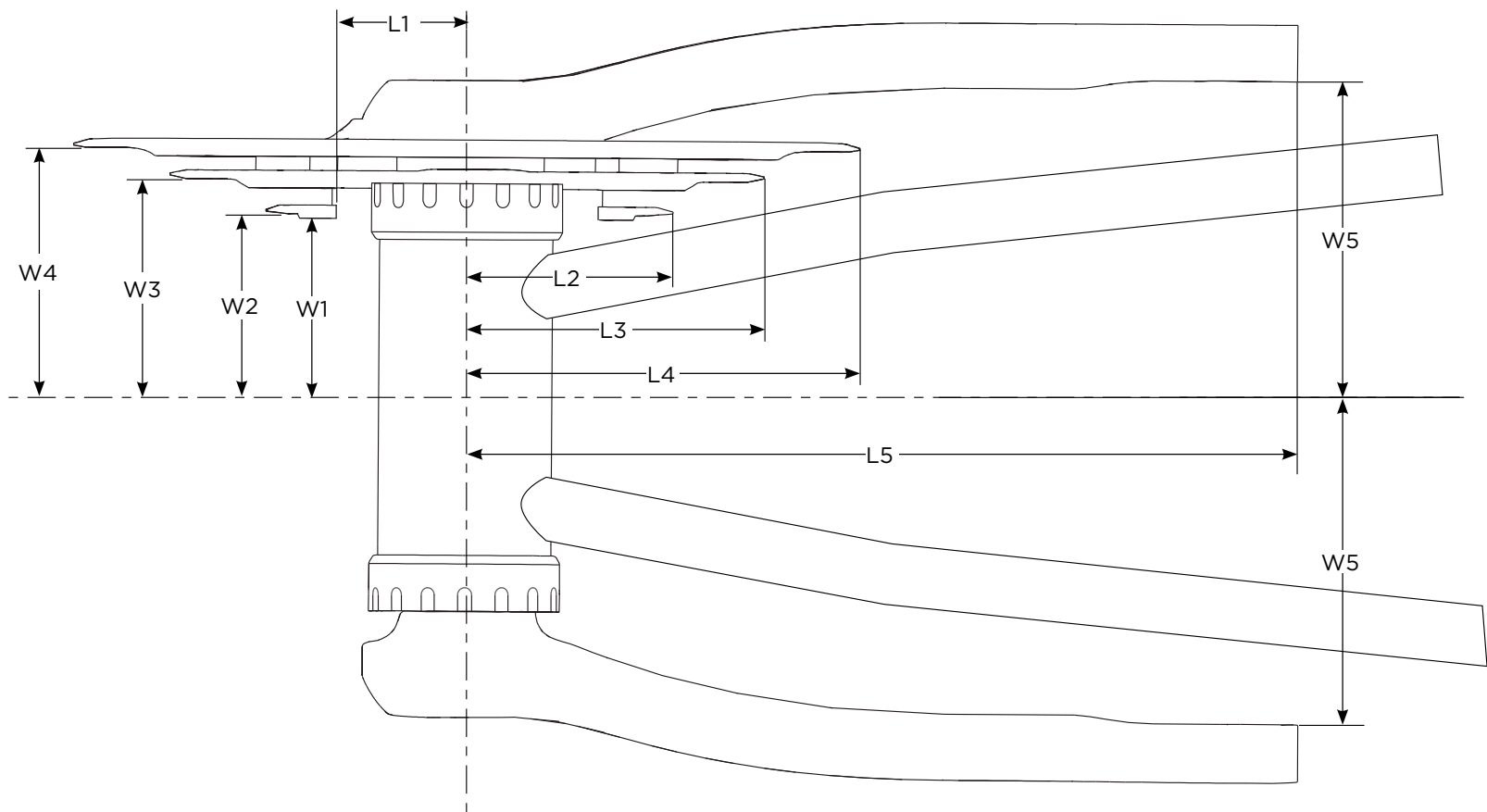

X9 Cranksets [2x10]

CRANKSET FRAME CLEARANCE INFORMATION										
Chain Ring Combination	L1	L2	L3	L4	L5	W1	W2	W3	W4	W5 (min)
38/24	24.5 mm	50.7 mm	79.1 mm	82.5 mm (rockguard)	192 mm (175 mm crank arm length)	41 mm	42 mm	57 mm	55.8 mm (rockguard)	72.9 mm
39/26	31 mm	55 mm	81 mm	-		43.5 mm	44.5 mm	52.5 mm	-	
42/28		60 mm	87 mm							
Q-factor										Q170.9
Bottom Bracket Type(s)										GXP: BB30 : PressFit™ 30 PressFit™ GXP MTB

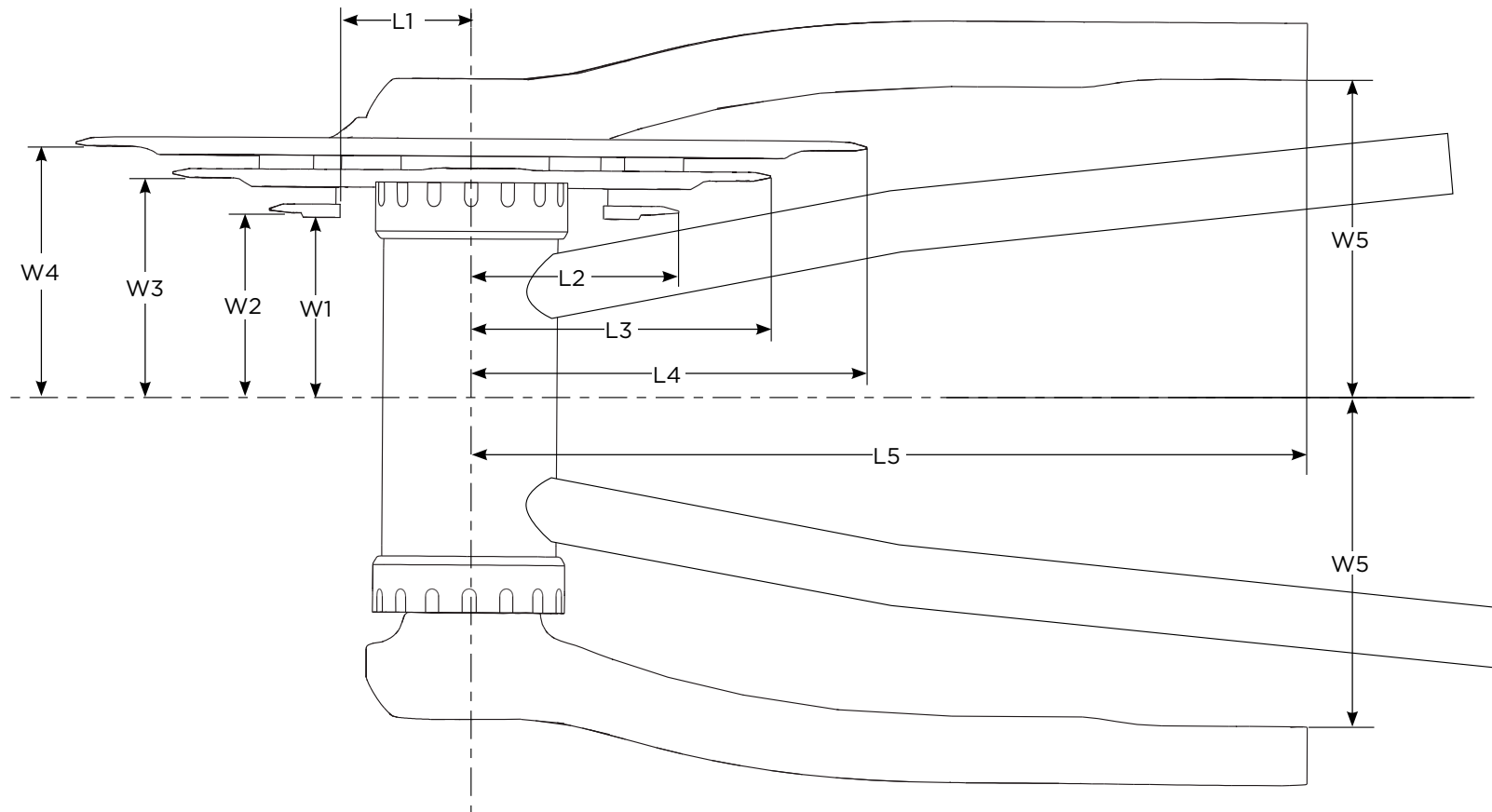

X9 Cranksets [3x10]

CRANKSET [3x10]	CRANKSET FRAME CLEARANCE INFORMATION										
	Chain Ring Combination	L1	L2	L3	L4	L5	W1	W2	W3	W4	W5 (min)
	44/33/22	25 mm	47 mm	69 mm	91 mm	192 mm (175 mm crank arm length)	41 mm	42 mm	50 mm	57 mm	72.9 mm
	Q-factor										Q170.9
Bottom Bracket Type(s)										GXP : BB30 : PressFit™ 30 PressFit™ GXP MTB	

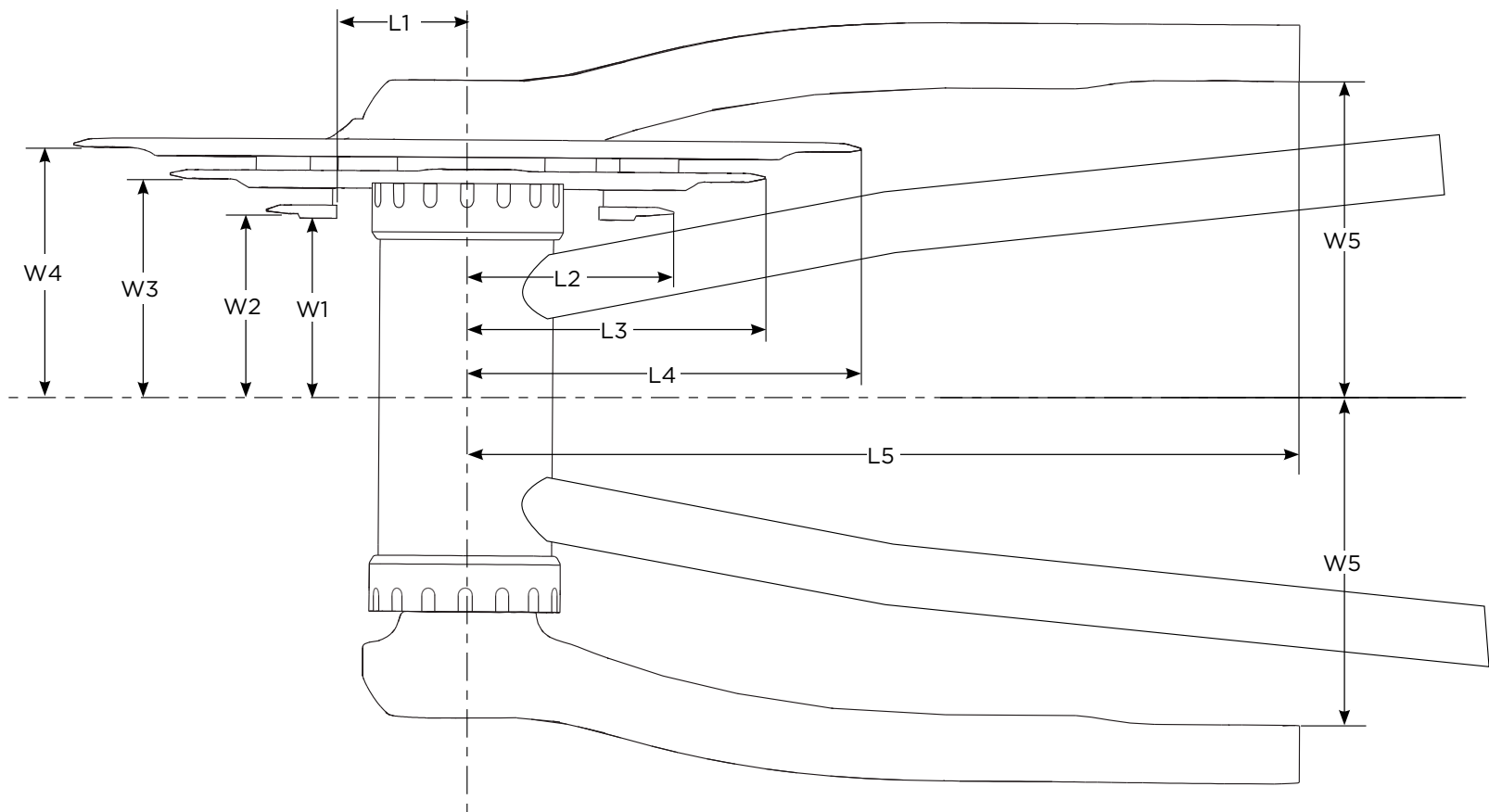

X7 Cranksets [2x10]

CRANKSET FRAME CLEARANCE INFORMATION											
Chain Ring Combination	L1	L2	L3	L4	L5	W1	W2	W3	W4	W4 (min)	
38/24	24.5 mm	50.7 mm	79.1 mm	82.5 mm (rockguard)	192 mm (175 mm crank arm length)	41 mm	42 mm	57 mm	55.8 mm (rockguard)	72.9 mm	
39/26	31 mm	55 mm	81 mm	-		43.5 mm	44.5 mm	52.5 mm	-		
42/28		60 mm	87 mm								
Q-factor										Q170.9	
Bottom Bracket Type(s)										GXP : BB30 : PressFit™ 30 PressFit™ GXP MTB	

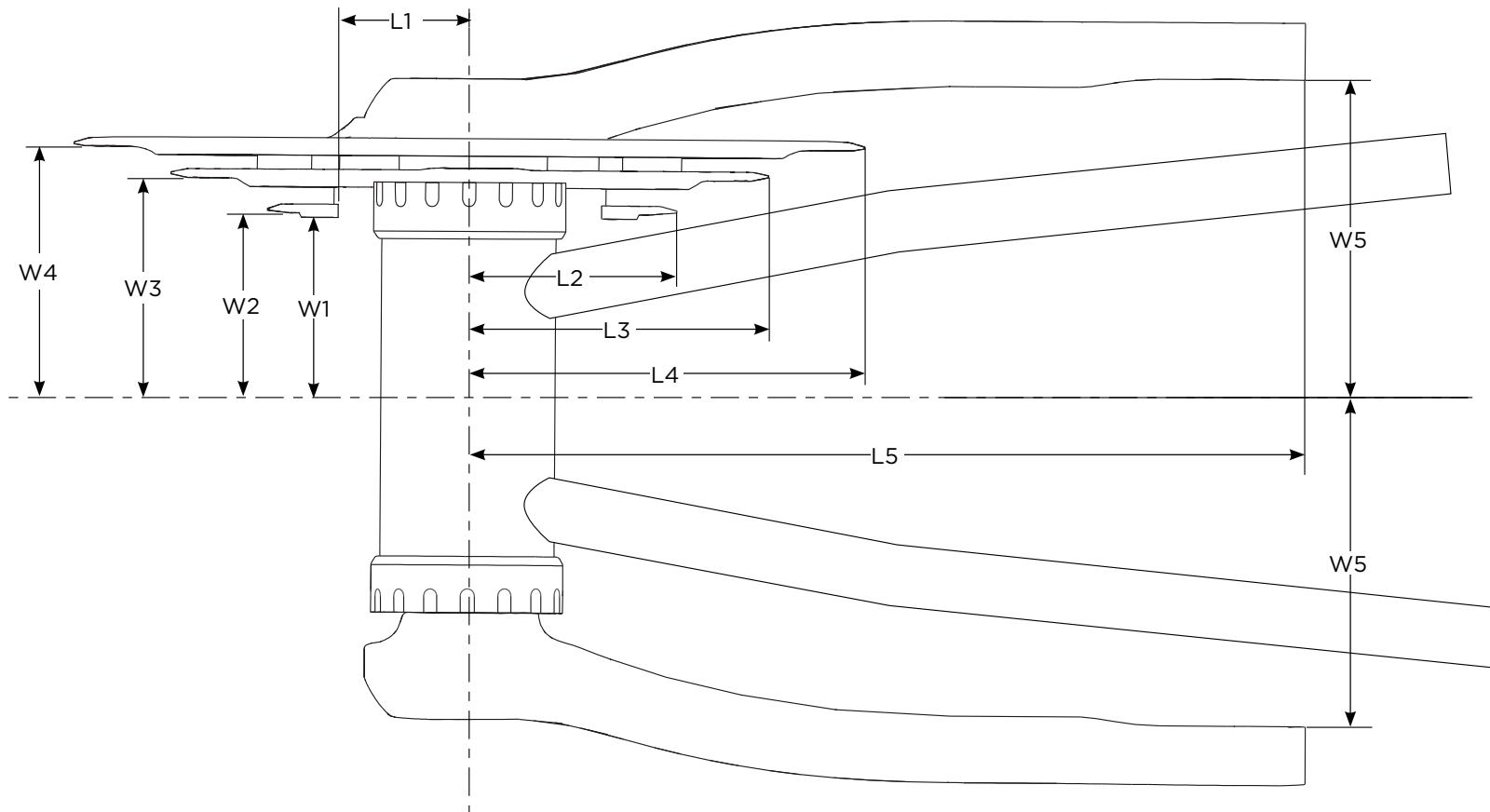

X7 Cranksets [3x10]

CRANKSET [3x10]	CRANKSET FRAME CLEARANCE INFORMATION										
	Chain Ring Combination	L1	L2	L3	L4	L5	W1	W2	W3	W4	W5 (min)
	44/33/22	25 mm	47 mm	69 mm	91 mm	191 mm (180 mm crank arm length)	41 mm	42 mm	50 mm	57 mm	70.5 mm
	Q-factor										Q167.5
Bottom Bracket Type(s)										GXP : BB30 : PressFit™ 30 PressFit™ GXP MTB	

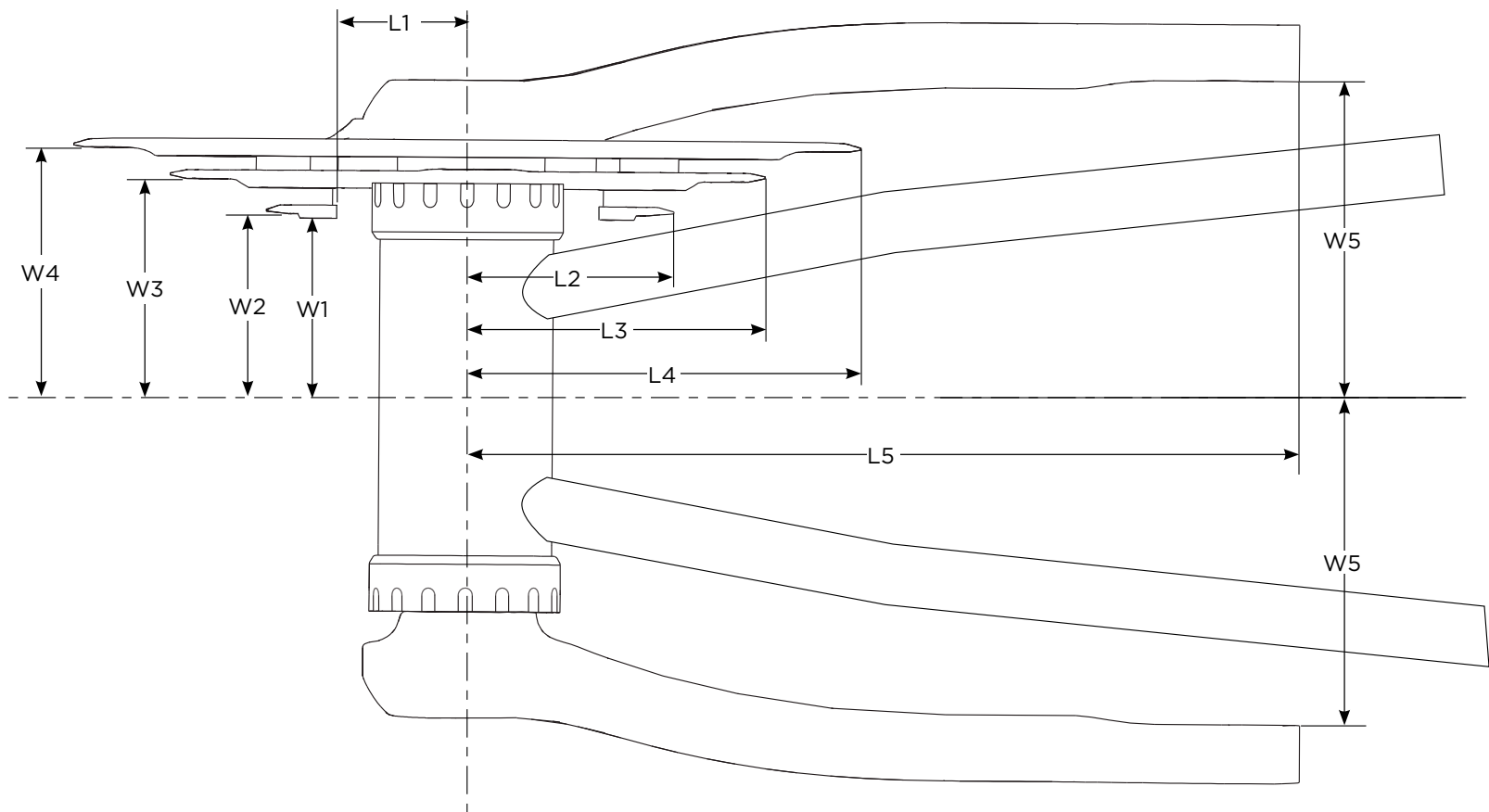

X5 Cranksets [2x10]

CRANKSET FRAME CLEARANCE INFORMATION										
Chain Ring Combination	L1	L2	L3	L4	L5	W1	W2	W3	W4	W5 (min)
38/24	24.5 mm	50.7 mm	79.1 mm	82.5 mm (rockguard)	192 mm (175 mm crank arm length)	41 mm	42 mm	57 mm	55.8 mm (rockguard)	72 mm
39/26	31 mm	55 mm	81 mm	-		43.5 mm	44.5 mm	52.5 mm	-	
42/28		60 mm	87 mm							
Q-factor										Q170.9
Bottom Bracket Type(s)										GXP : BB30 : PressFit™ 30 PressFit™ GXP MTB

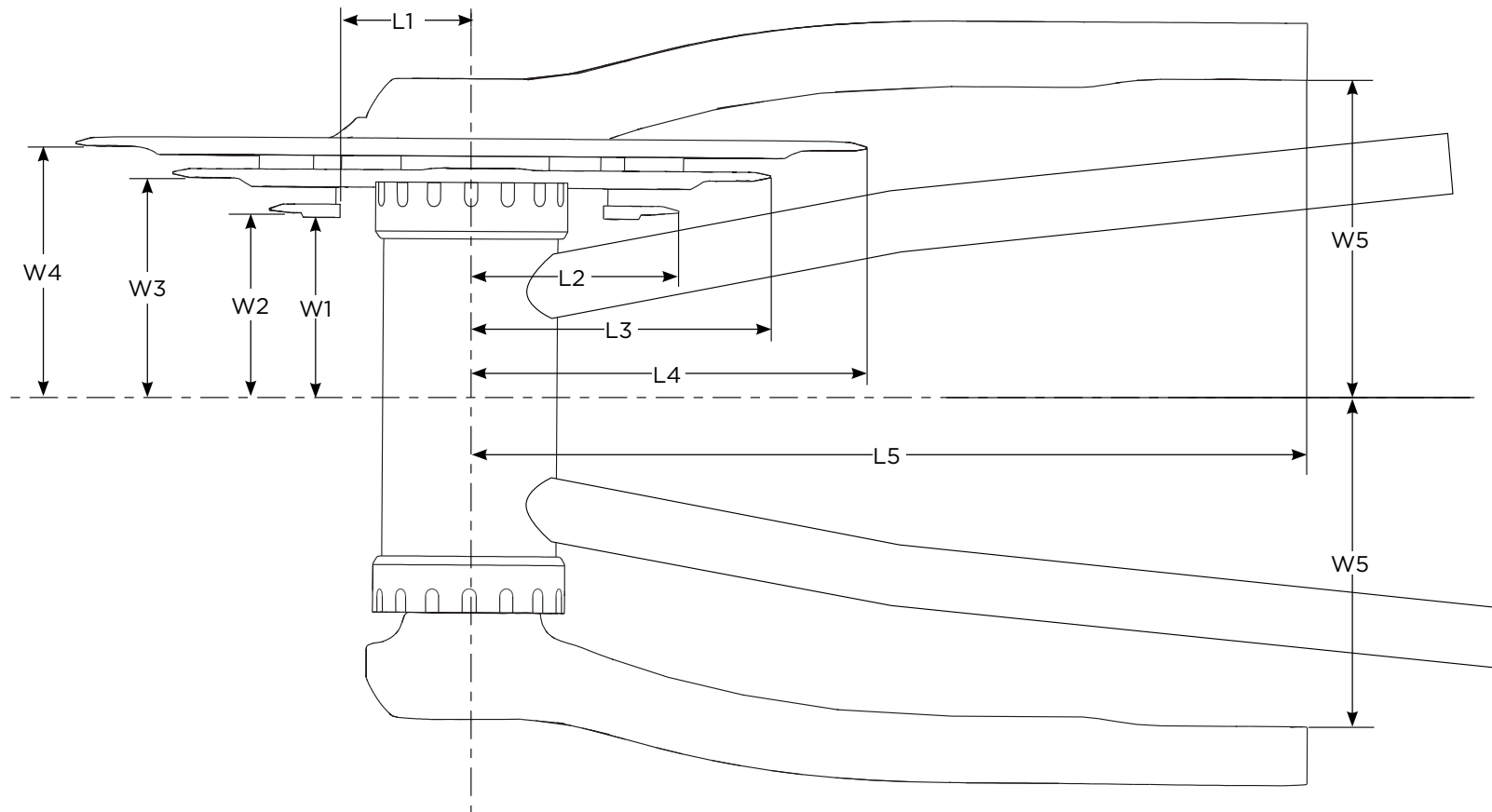

X5 Cranksets [3x10]

	CRANKSET FRAME CLEARANCE INFORMATION										
	Chain Ring Combination	L1	L2	L3	L4	L5	W1	W2	W3	W4	W5
CRANKSET [3x10]	44/33/22	25 mm	47 mm	69 mm	91 mm	191 mm (180 mm crank arm length)	41 mm	42 mm	50 mm	57 mm	72 mm
	Q-factor										Q167.5
	Bottom Bracket Type(s)										GXP : BB30 : PressFit™ 30 PressFit™ GXP MTB

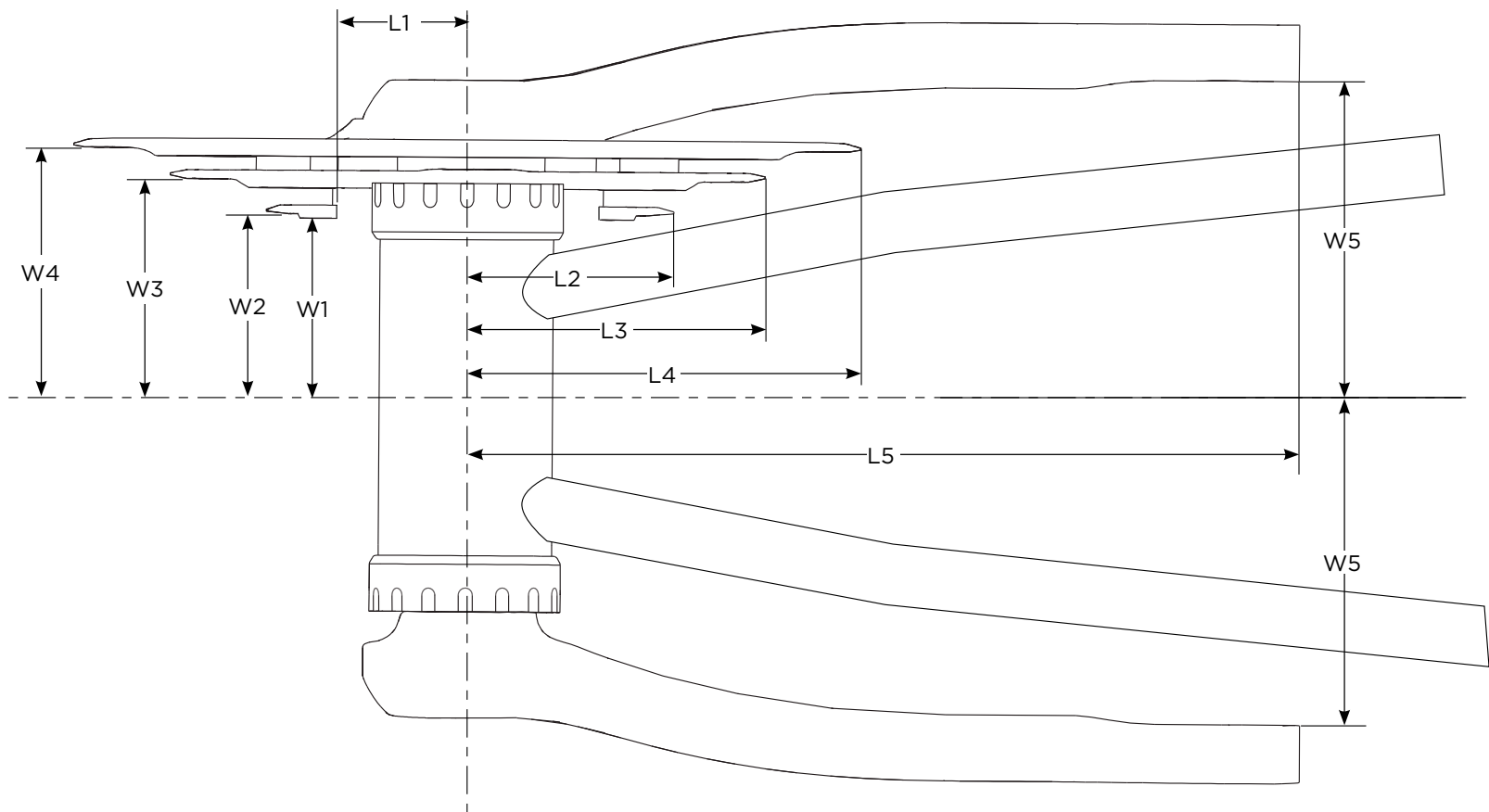

Bottom Brackets

(All dimensions in millimeters unless otherwise indicated - not to scale)



1. DIMENSIONS APPLY AFTER FINISHING.
2. ONLY DIMENSIONS ESSENTIAL TO BOTTOM BRACKET PRESS FIT AND FUNCTION ARE SHOWN. ALL OTHER DETAILS ARE LEFT TO THE DISCRETION OF THE FRAME OR CRANKSET DESIGNER. DIMENSIONS SHOWN DO NOT TAKE THE PLACE OF PROPER FRAME, BOTTOM BRACKET SHELL, OR CRANKSET DESIGN.

- 3 PRESSFIT SURFACES SHOULD BE UNPAINTED.
- 4 TOLERANCE APPLIES TO DEPTH OF 13.00 mm FROM SURFACE EACH SIDE.
- 5 RECOMMENDED 68.00 mm FOR ROAD APPLICATIONS 73.00 mm FOR MTB APPLICATIONS

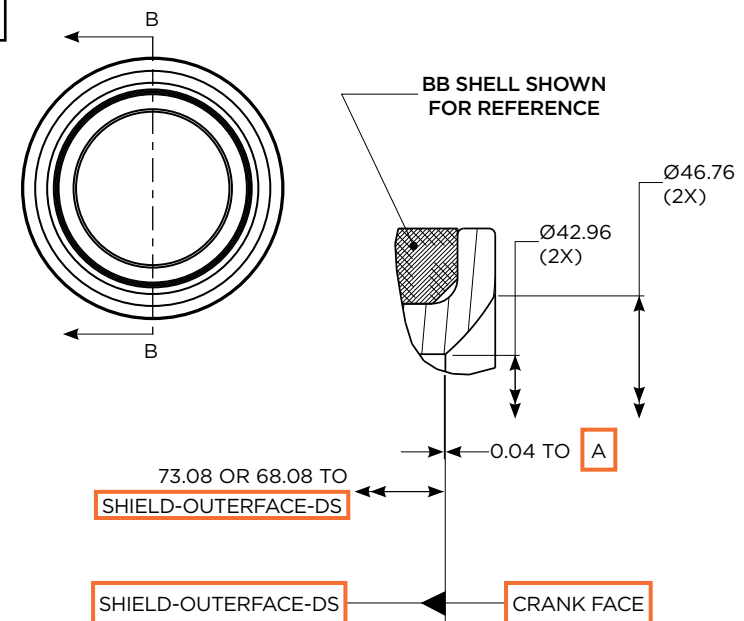

SECTION B-B
DETAIL Z: CRANK - BOTTOM BRACKET INTERFACE

PRESSFIT™ GXP BB

(All dimensions in millimeters unless otherwise indicated - not to scale)

PRESSFIT GXP BB SHELL SPECIFICATION

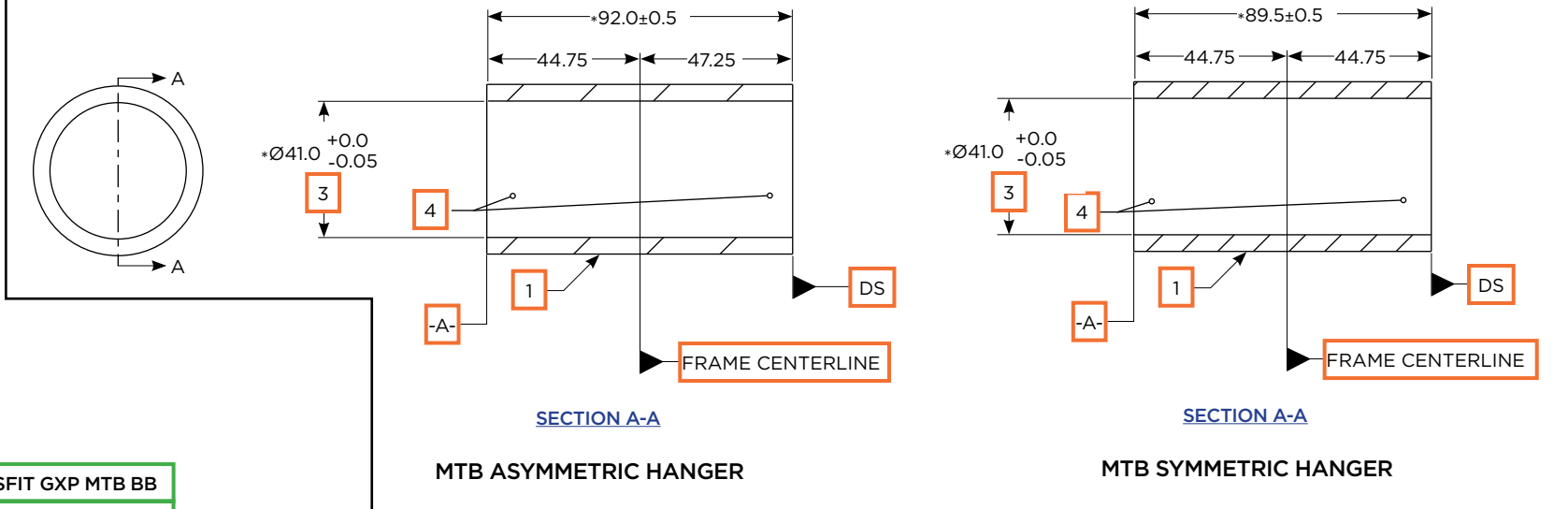

PRESSFIT GXP MTB BB

KEY DIMENSIONS

ITEM NO.	QTY.	DESCRIPTION
1	1	WAVE WASHER
2	1	DS SHIELD
3	1	NDS SHIELD
4	1	DS CUP
5	1	NDS CUP
6	1	DS SPACER

NOTES:

- 1 PRESSFIT GXP MTB BOTTOM BRACKET IS ONLY COMPATIBLE WITH THE SHOWN BOTTOM BRACKET SHELL SPECIFICATIONS.
- 2 ONLY DIMENSIONS ESSENTIAL TO BOTTOM BRACKET PRESS FIT AND FUNCTION ARE SHOWN. DIMENSIONS APPLY AFTER FINISHING
- 3 TOLERANCE APPLIES TO DEPTH OF 12.00 mm FROM SURFACE **A** EACH SIDE.
- 4 PRESSFIT SURFACES SHOULD BE UNPAINTED.

